



Low-Cost Exit Solution with **Exit Release Button**



For the purpose of cost-concerns, to complete a door access system, you may install a low-cost Exit Release Button for an exit with low security threshold environment. The door release button can be used as a general exit release button or as an emergency release switch. The button is fireproof, easy to install and integrates seamlessly with the AdapTec Plus.

INSTALLATION DIAGRAM

**for illustration purposes only*

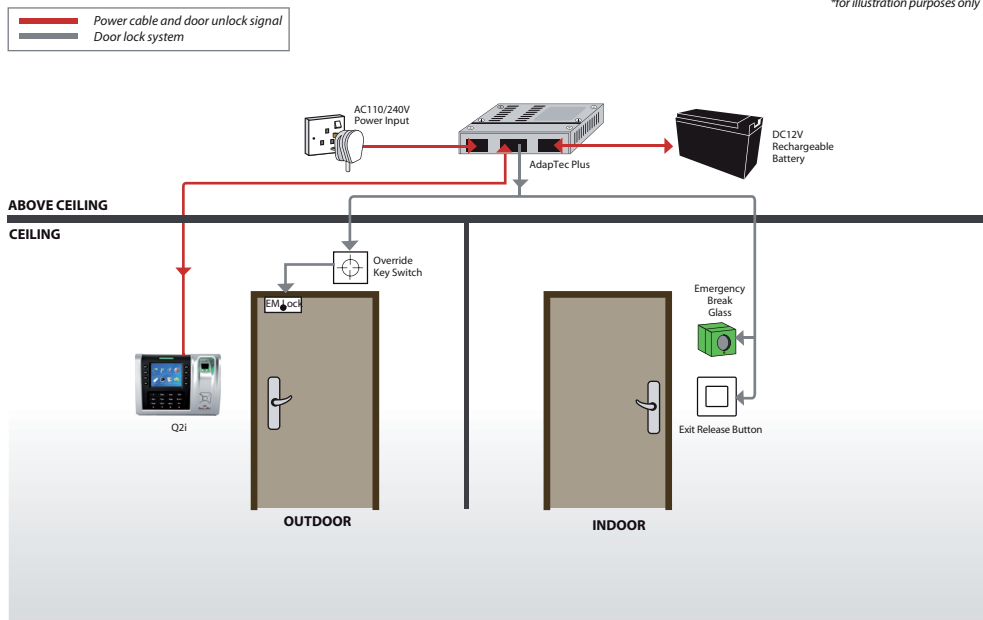

SPECIFICATIONS

DIMENSIONS (MM)	86 x 6 x 86
WEIGHT	40g
SURFACE FINISHING	Hard Plastic
MAXIMUM POWER RATING	Max DC36A 3a
OPERATING TEMPERATURE	0°C ~ 60°C
OUTPUTS	NC
APPLICATIONS	Gate / Door / Exit / Automation Control

FEATURES & BENEFITS

- Simple & neat design, fits any environment.
- Easy to Install
- Save cost, no need to install exit terminal.

